

# LEX28 Order Form

**AUDIO VISUAL  
FURNITURE  
International**

Date \_\_\_\_\_  
AVFI Sales REP \_\_\_\_\_  
Customer Signature \_\_\_\_\_

Quote No. \_\_\_\_\_  
Customer No. \_\_\_\_\_  
AVFI No. \_\_\_\_\_

Office Use Only

To generate your order form, please refer to the information provided below to insert the alphabetic and/or numeric code in the respective category boxes. Please note that without this filled out Order Form, your purchase **cannot** be processed.

1	2	3	4
Product Model	Finish	Chargeable Accessories (One Code Per Box)	Custom Cutouts
<b>LEX28</b>			

## 1 Choose Model Style (Front Panel)



Code **LEX28**

## 2 Choose Product Finish

**Standard Finishes** (Ships within 1-15 business days)



Code **RCT**  
(River Cherry)



Code **ELT**  
(Elegance)



Code **EBT**  
(Ebony)

**Optional Finishes** (Ships within 20 business days)



**FMT**



**CJT**



**HCT**



**ART**



**BRT**



**CLT**



**SGT**



**CWT**



**BAT**

## 3 Chargeable Accessories (Check all that apply)

- Code **00** No Accessories \_\_\_\_\_ Qty \_\_\_\_\_
- \* Code **D1** **MIC-18** MX418 S/C Microphone \_\_\_\_\_ Qty \_\_\_\_\_
- \* Code **D2** **LIGHT-18** Gooseneck Light \_\_\_\_\_ Qty \_\_\_\_\_
- \* Code **D3** **FM3** Timer/Clock \_\_\_\_\_ Qty \_\_\_\_\_
- \* Code **D6** **GRC60B** Black 60mm Round Grommet \_\_\_\_\_ Qty \_\_\_\_\_
- \* Code **D7** **GRC60W** White 60mm Round Grommet \_\_\_\_\_ Qty \_\_\_\_\_
- \* Code **D8** **GRC60G** Grey 60mm Round Grommet \_\_\_\_\_ Qty \_\_\_\_\_
- \* Code **E1** **PB** 6 Outlet Power Bar \_\_\_\_\_ Qty \_\_\_\_\_
- \* Code **E3** **CUB3** Round Cable Well \_\_\_\_\_ Qty \_\_\_\_\_
- \* Code **E5** **CUB5** Black Round Cable Well \_\_\_\_\_ Qty \_\_\_\_\_
- \* Code **E6** **CUB5** Silver Round Cable Well \_\_\_\_\_ Qty \_\_\_\_\_
- \* Code **E7** **PC-PATCH** Power-Data Module \_\_\_\_\_ Qty \_\_\_\_\_
- \* Code **E8** **CUB8** Tabletop Cable Well \_\_\_\_\_ Qty \_\_\_\_\_
- \* Code **EA** **CUB4S** Silver Power Panel \_\_\_\_\_ Qty \_\_\_\_\_
- \* Code **EB** **CUB4B** Black Power Panel \_\_\_\_\_ Qty \_\_\_\_\_
- \* Code **EJ** **CUB22** 3 Module Power Panel (Black) \_\_\_\_\_ Qty \_\_\_\_\_
- \* Code **EK** **CUBM3** 3 Module Power & Data Panel (Black) \_\_\_\_\_ Qty \_\_\_\_\_
- \* Code **EL** **CUBM4** 4 Module Power & Data Panel (Black) \_\_\_\_\_ Qty \_\_\_\_\_

\* Cutout Required (Extra Charges will apply)

## 4 Custom Cutout Option (Extra charges will apply)

Please indicate custom cutout location on the drawing below

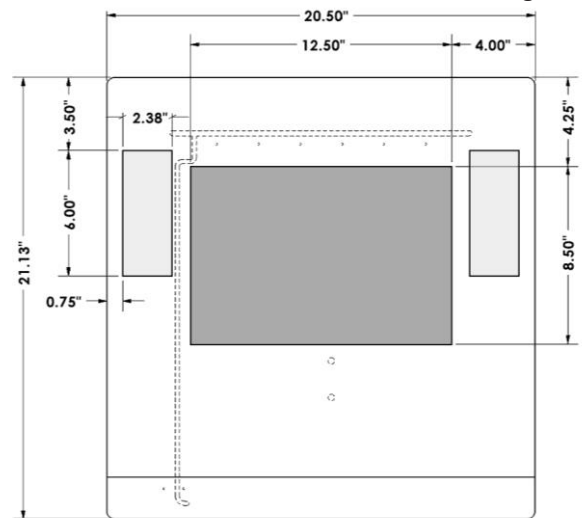

Code **CO** No Custom Cutout

Code **CC** Custom Cutout (Specify on Cutout Area Above)

☐ Sides cutout Area (2x - 2.375" W x 6.0" D)

☐ Center cutout Area (1x - 12.50" W x 8.50" D)

## Notes

### CAD Drawings/Symbols

CAD drawings are available by request at [sales@vegroup.net](mailto:sales@vegroup.net)

**Custom Cutouts** Estimated lead time within 20 business days from receipt of P.O. and signed drawings.

### Customizations

Modifications to design such as shape and/or size variations have to be quoted on a per case basis and are applicable for quantities of 10+ only.

Comments (Please use this section to provide additional information)